

SITE PLAN OF PROPOSED G+III STOREYED RESIDENTIAL BUILDING AT PREMISES NO.-  
42, SWAMI SATYA NANDA SARANI, KOLKATA-36, MOUZA-BARANAGAR, J.L. NO.-5,  
R.S. NO.-6, TOUZI NO.:1068/2833, R.S. DAG NO.-3846,1194, R.S. KHATIAN NO.-2329,4008,4009,4010,  
HOLDING NO.-805, WARD NO.-31, DIST.-N 24 PGS. UNDER BARANAGAR MUNICIPALITY.

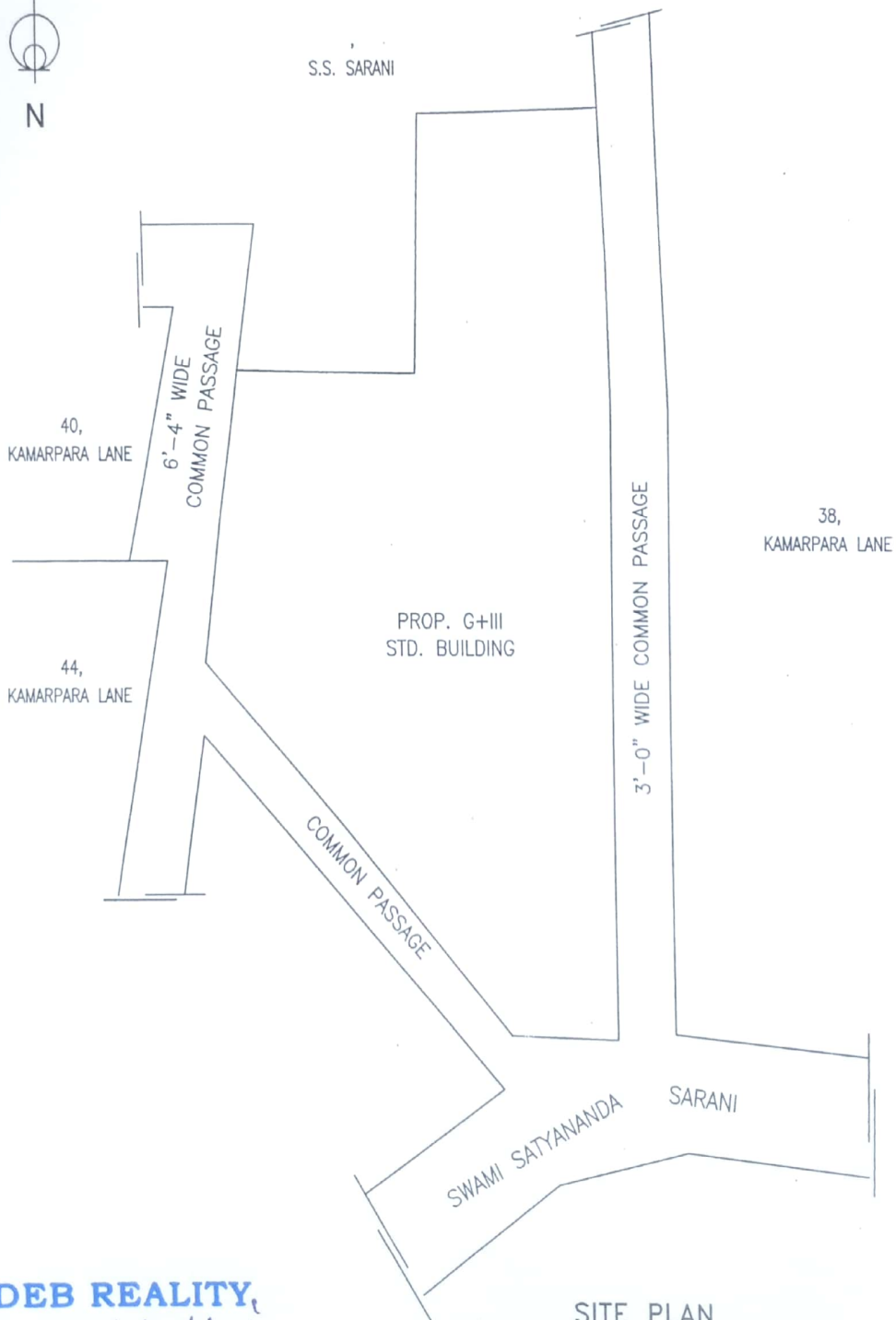

**DEB REALITY,**  
*Debraj Mukherjee*  
Proprietor

**SITE PLAN**  
SCALE = 1:200

PLAN OF SHOWING LOCATION OF SUB-MERSIBLE PUM AND O.H. TANK AT PREMISES NO.-  
42, SWAMI SATYA NANDA SARANI, KOLKATA-36, MOUZA-BARANAGAR, J.L. NO.-5,  
R.S. NO.-6, TOUZI NO.:1068/2833, R.S. DAG NO.-3846,1194, R.S. KHATIAN NO.-2329,4008,4009,4010,  
HOLDING NO.-805, WARD NO.-31, DIST.-N 24 PGS. UNDER BARANAGAR MUNICIPALITY.

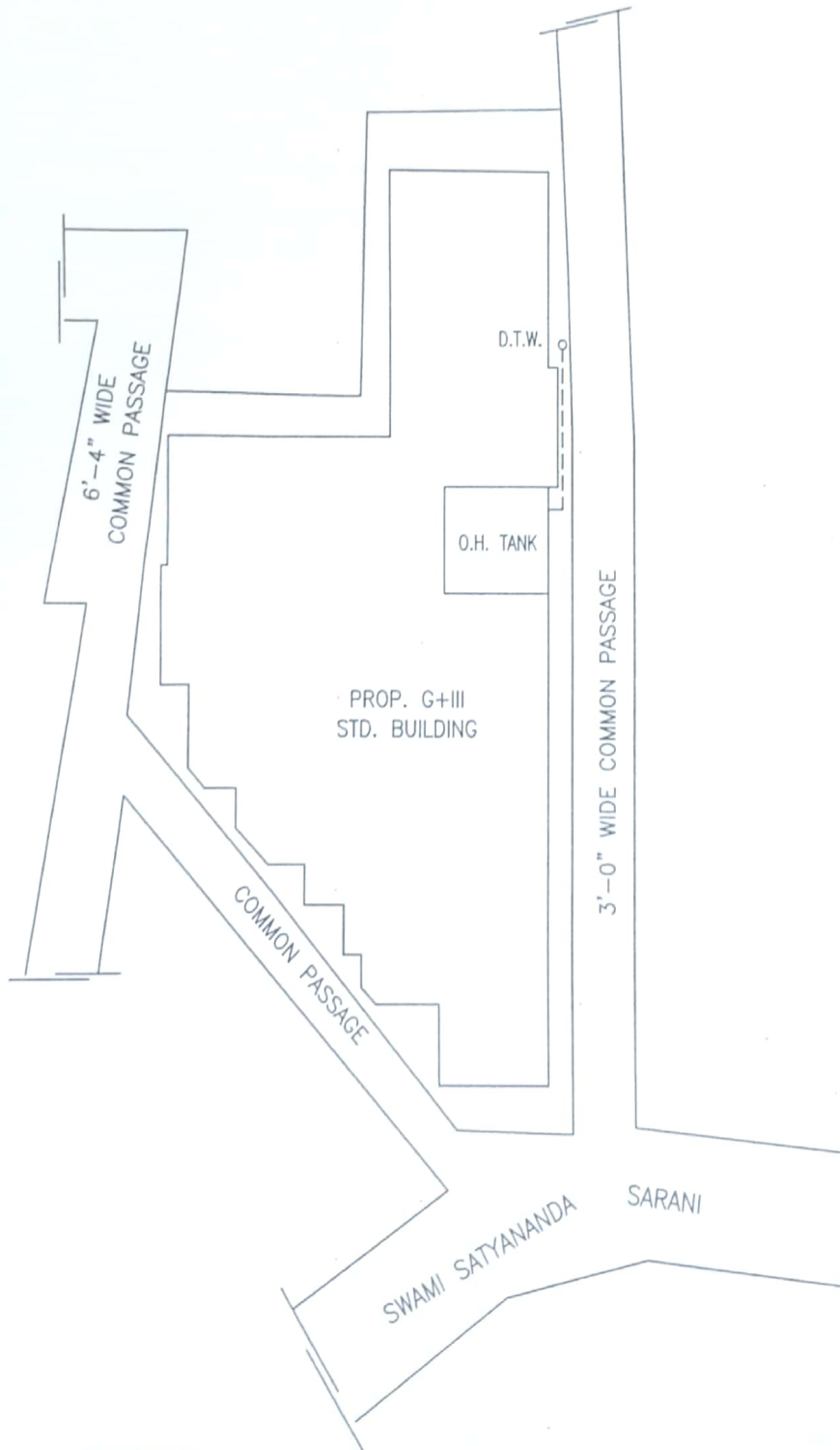

**DEB REALITY**  
*Debroy Mukherjee*  
Proprietor

LOCATION PLAN OF SUB-MERSIBLE PUMP  
SCALE = 1:200